

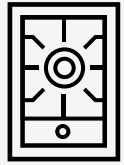

Thinking of you
Electrolux



.....
User manual

.....
Integrated burner

.....
EQBW40AS



WE'RE THINKING OF YOU

Thank you for purchasing an Electrolux appliance. You've chosen a product that brings with it decades of professional experience and innovation. Ingenious and stylish, it has been designed with you in mind. So whenever you use it, you can be safe in the knowledge that you'll get great results every time. Welcome to Electrolux.

BEFORE USING YOUR APPLIANCE

Check for any damage or marks. If you find the appliance damaged or marked you must report it within 7 days to claim for damages under the manufacturers warranty.

Before you use the appliance, we recommend that you read through the whole user manual which provides the description of the product and its functions. To avoid the risks that are always present when you use a gas appliance, it is important that the product is installed correctly and that you read the safety instructions carefully to avoid misuse and hazards.

For future reference, please store this booklet in a safe place.

This appliance complies with the requirements of Australian Standard AS4557.

BEFORE YOU CALL

Please ensure you read the instruction manual fully before you call for service, or a full service fee could be applicable.

RECORD MODEL AND SERIAL NUMBER HERE:

Model: _____

Serial No: _____

CONTENTS

3	General warnings
4	Electrolux Integrated burner product description
6	Gas specifications
6	Gas connection detail
7	Natural Gas installation
8	Leak test procedure
8	Universal LPG installation
10	Gas bottle safety information
10	Installation warnings
11	Installation instructions
12	Gas requirements
13	Locating integrated burner adjacent to integrated barbecue
13	Connecting with Electrolux integrated barbecue
14	Setting up the burner
14	Burner operation
15	Pivoting lid safety leg
16	Cleaning and care
16	Maintenance
17	Troubleshooting
17	Accessories
19	Warranty

SYMBOLS



WARNING!

This symbol indicates information concerning your personal safety.



CAUTION!

This symbol indicates information on how to avoid damaging the appliance.



IMPORTANT!

This symbol indicates tips and information about use of the appliance.



ENVIRONMENT!

This symbol indicates tips and information about economical and ecological use of the appliance.

GENERAL WARNINGS

Please read the user manual carefully and store in a handy place for later reference. Pass the user manual on to possible new owners of the appliance.

Read the following carefully to avoid damage or injury.

NOTE! You must read these warnings carefully before installing or using the appliance. If you need assistance, contact your Customer Care Department. The manufacturer will not accept liability, should these instructions or any other safety instructions incorporated in this book be ignored.

For your safety please read this book before operating your barbecue.

WARNING!

This appliance MUST be installed and serviced only by a qualified licensed person.

Improper installation, adjustment, alteration or maintenance can cause injury or property damage. Please contact your nearest Electrolux Service Department for additional information or assistance for an approved installer.

NOTE TO THE INSTALLER

THIS MANUAL MUST REMAIN WITH THE OWNER FOR FUTURE REFERENCE.

WARNING!

IF YOU SMELL GAS, do not attempt to light the burner. Locate the leak and re-tighten the leaking joint. Carry out the Leak Test procedure as described in this manual. If the leak persists, turn off the gas supply and call Electrolux Service Centre or a Licensed Gas Fitter.

WARNING!

- Do not lean over barbecue when lighting.
- Do not leave the barbecue unattended when alight.
- Do not delay lighting once the gas has been turned on.
- Do not store or use aerosol cans in the vicinity of the barbecue.
- Do not store flammable liquids in the vicinity of the barbecue.
- Do not use caustic or abrasive based cleaners on the barbecue.
- Do not operate the barbecue with the cover on.
- Do not attempt to dismantle or adjust the control valves.
- Do not attempt to dismantle or adjust the regulator.
- Do not test for leaks with a naked flame.
- Do not modify the construction of this appliance or modify the injector orifice size.
- Do not obstruct any ventilation of the barbecue.
- Do not allow children to operate or play near the barbecue.

CAUTION!

This barbecue is supplied set up for Natural Gas and is labelled accordingly. A Universal LPG conversion kit is included if required. Conversion of this unit to Universal LPG must be carried out by a qualified licensed person and a Certificate of Compliance must be issued to the owner on completion of the installation and conversion.

INTEGRATED BURNER

- 1 Slimline lid
- 2 Gas connection point

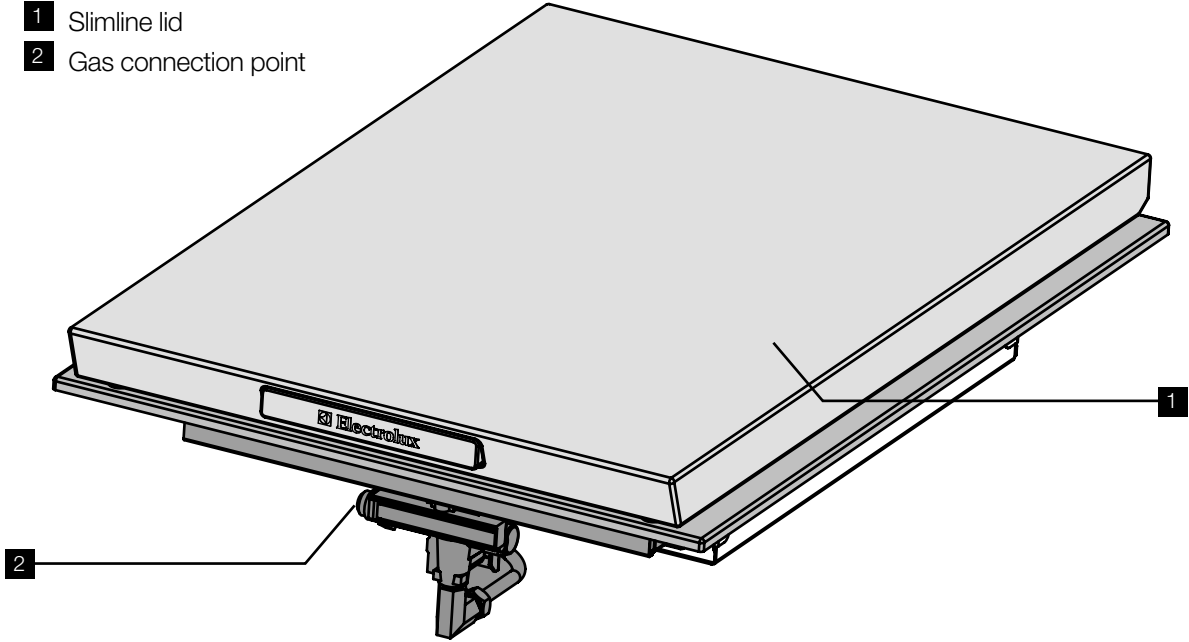

- 9 Weatherproof cover EQB40ACBL

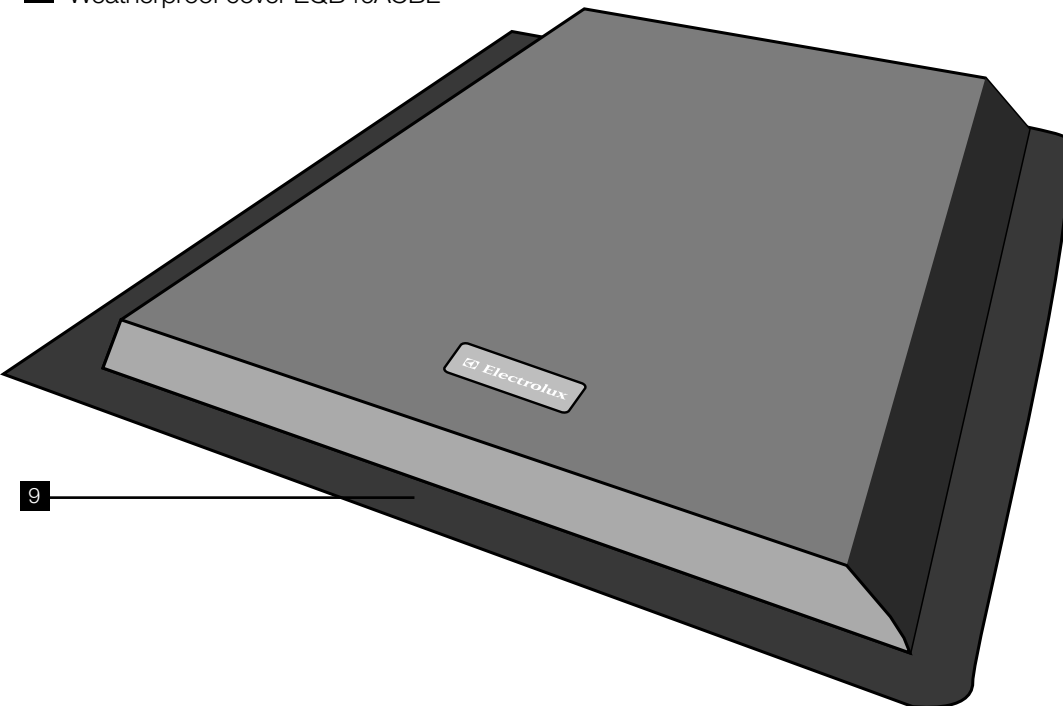

- 3 Pivoting lid safety leg
- 4 Lid mounting bracket
- 5 Trivet
- 6 Burner caps
- 7 Burner crown
- 8 Burner control

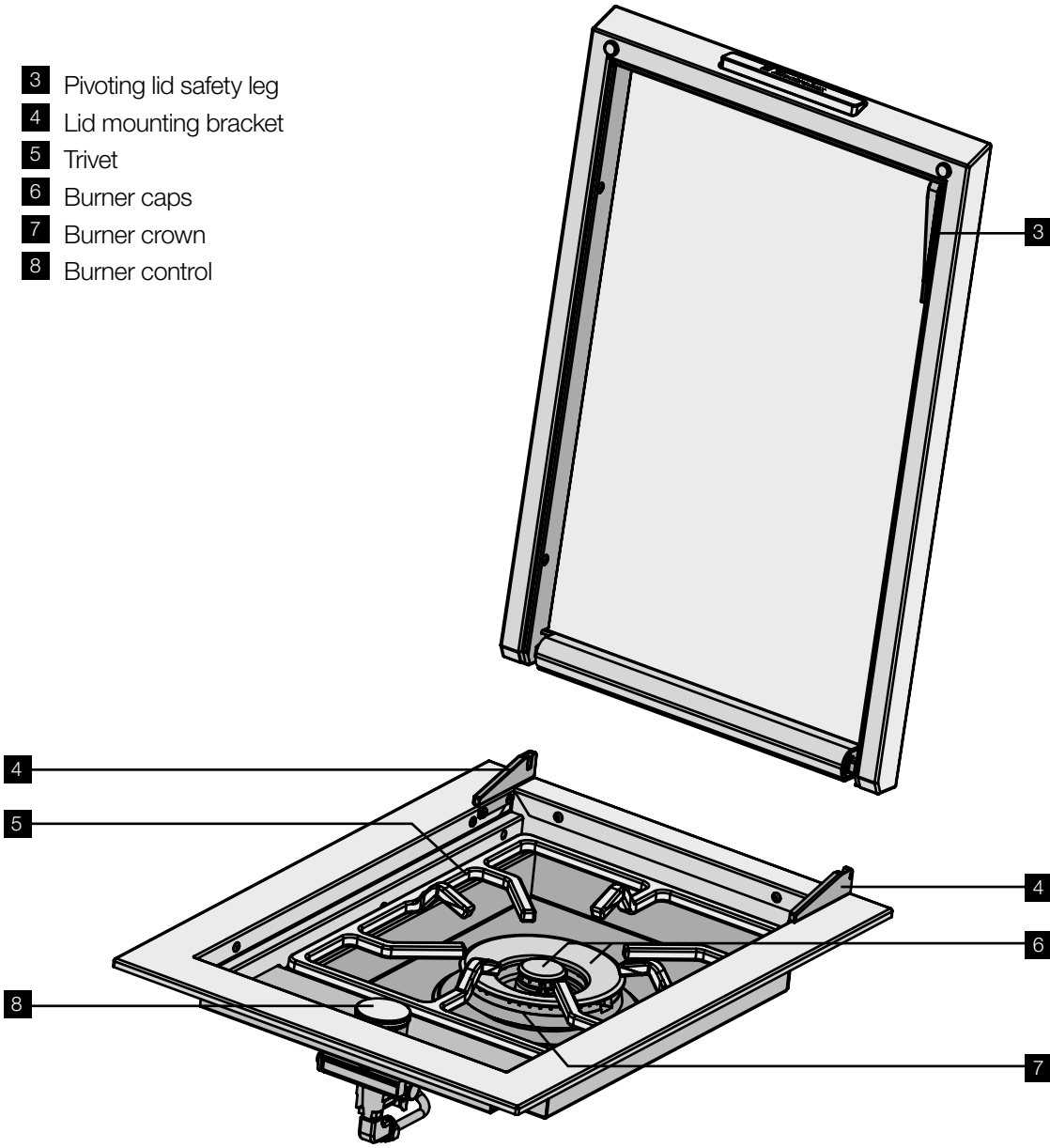

GAS SPECIFICATIONS

Gas type	Natural gas	Universal LPG
Maximum gas consumption	13.5 MJ/h	11 MJ/h
Injector orifice diameter (mm)	1.80mm	0.95mm
Number of injectors	1	1
Regulator pressure	1.00 kPa	2.75 kPa

NOTES:

- *This appliance MUST be installed and serviced only by a qualified licensed person.*
- *This product is intended for outdoor use only.*
- *Ventilation holes in the unit must not be obscured by the installation.*

GAS CONNECTION DETAIL

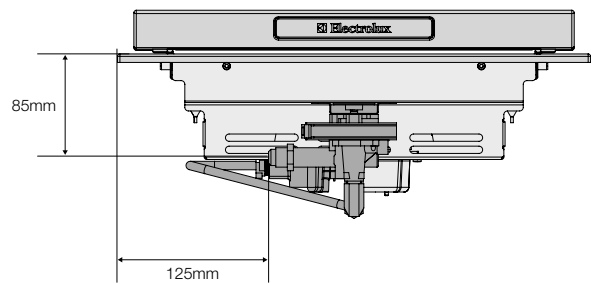
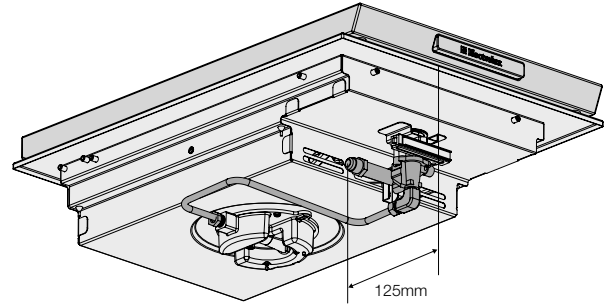

NATURAL GAS INSTALLATION

Preparing the unit for Natural Gas connection to mains

For Natural Gas connection, a bayonet connection point should be installed by a licensed gas fitter prior to installing the unit.

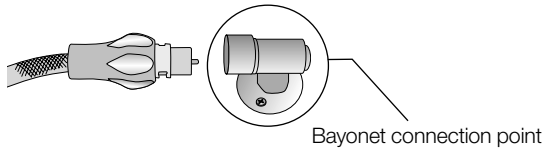

5. Fit to mains
 - Connect the bayonet end to mains

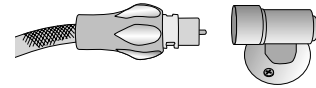

6. Ensure routing of gas supply hose prevents the hose from contacting hot surfaces of burner base or burner box.

Preparing the unit for Natural Gas installation

This burner is supplied set up for Natural Gas and is labelled accordingly. A Universal LPG conversion kit is included if required. Conversion of this unit to Universal LPG must be carried out by a qualified licensed person. A Certificate of Compliance must be issued to the owner on completion of the installation and conversion. When tightening the regulator or any other connection do not over-tighten.

1. Fit flexible black hose to the gas inlet.
Do not over-tighten.
2. Fit the brass adaptor to the black flexible hose.
Do not over-tighten.
3. Fit the regulator to the adaptor with fibre washer ensuring that fibre washer seated correctly into adaptor. Do not over-tighten.
4. Fit the hose to the regulator
 - Apply thread tape or sealant to the male thread on the hose and screw into the regulator.
Do not over-tighten.

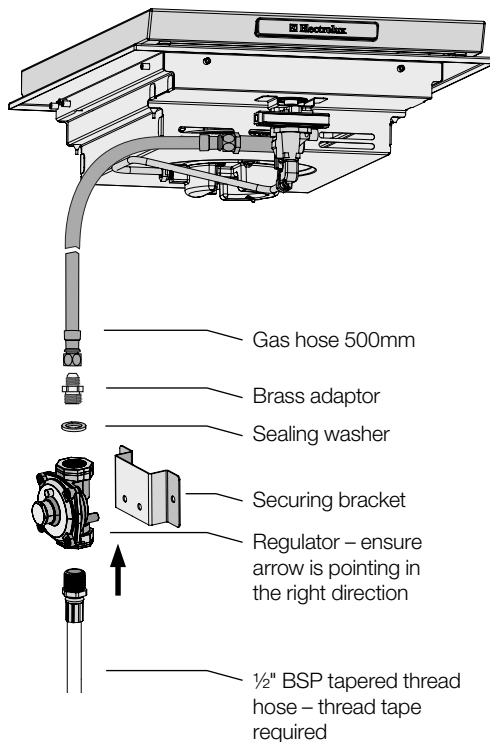

LEAK TEST PROCEDURE

- Ensure gas valve is in the 'OFF' position.
- In a small container, mix a solution of water and detergent or soap.
- After connection of the hose, turn on the valve at the gas bottle or mains as appropriate.
- Using a brush apply the solution to the gas connection points and look for bubbles forming.
- Bubbling will indicate a leak.
- Turn off the valve and re-tighten the joint. Repeat the leak test.
- If the leak persists, turn off the gas at the isolation valves and contact a licensed gas fitter to correct.

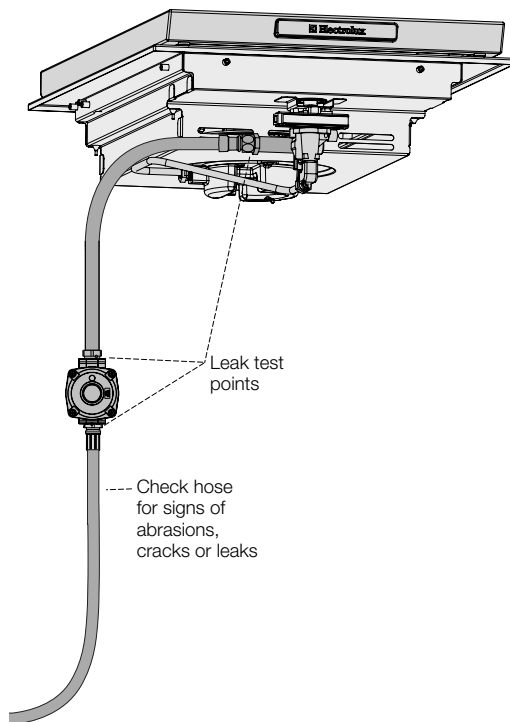

UNIVERSAL LPG INSTALLATION

Preparing the unit for Universal LPG installation

This burner is supplied set up for Natural Gas and is labelled accordingly. A Universal LPG conversion Kit is included to enable conversion to Universal LPG and connection to a 9kg bottle.

Remote ULPG supply

The barbecue can be plumbed into a remote or household ULPG supply. Never connect the barbecue to an unregulated supply, ensure supply pressure at the barbecue is 2.75kPa. Electrolux strongly recommends that a manual shut off valve be installed in the gas supply line in an accessible position so that the gas supply can be turned off in the event of an emergency, or during servicing.

NOTE: Conversion of this unit to Universal LPG must be carried out by a qualified licensed person and a Certificate of Compliance must be issued to the owner on completion of the installation and conversion. The required components for conversion have been supplied.

The components are:

- Hose and regulator assembly
- Universal LPG injector (0.95mm)
- Universal LPG gas type sticker

1. Change the injector.

- Remove trivet, burner crown and burner caps.

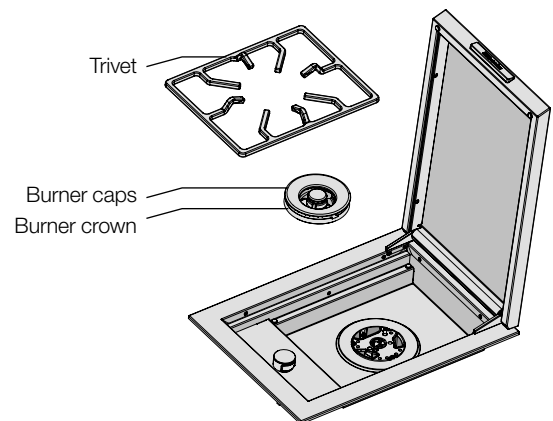

2. Remove injector.

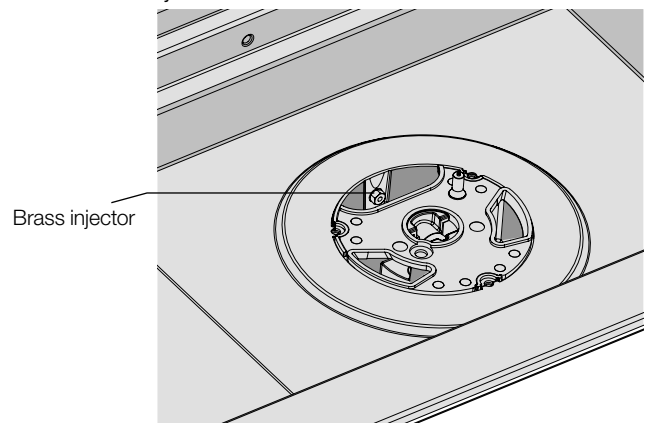

3. Replace natural gas injector (1.80mm hole) with ULPG injector (0.95mm hole).



4. Replace burner crown, burner caps and trivet, ensuring burner is seated correctly.
5. Fit LPG regulator and hose assembly to gas inlet and connect to gas bottle. See page 10 for gas bottle safety information.

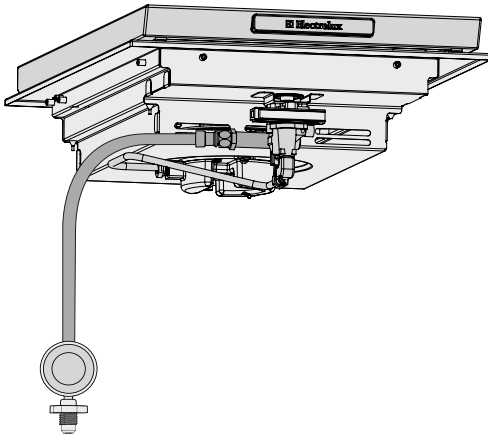

6. Conduct leak test for joints made at each end of hose. Refer leak test procedure on page 8.
7. Adjust the turndown setting on the valve. The turndown screw will need to be adjusted after unit is installed. This is done using the supplied thin blade screwdriver inserted through the hole in the centre of the shaft spindle (see diagram).

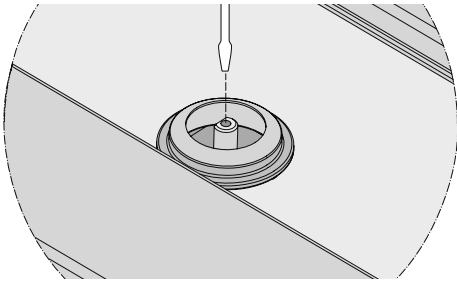

Following connection of gas as per step 5 and leak testing, light the burner and set to lowest setting. Remove the knob from the valve, and adjust turn down screw anti-clockwise approximately 1/4 turn to achieve a small steady flame.

8. Remove natural gas sticker on underside of lid and replace with universal LPG sticker provided.

GAS BOTTLE SAFETY INFORMATION

- This appliance once converted to use Universal LPG is designed to use a 9kg (20 lbs) gas cylinder.
- The gas cylinder must be made and marked in accordance with specifications for LPG cylinders.
- It is recommended to turn off the cylinder valve when the appliance is not in use.
- Gas cylinders must be stored in an approved housing out of reach of children.
- When disconnecting the gas bottle ensure that all the control valves are in the 'OFF' position.
- Remove the bottle from any housing in which it may be stored before disconnection.
- When reconnecting the hose to the bottle, ensure that all connections are tight before replacing in the storage compartment.
- Carry out a leakage check as detailed on page 8 after each re-connection.

INSTALLATION WARNINGS

WARNING!

- This appliance shall only be used in an above ground, open air situation with natural ventilation without stagnant areas, where gas leakage and products of combustion are rapidly dispersed by wind or natural convection. This barbecue has been designed for outdoor use only. Refer to diagrams below.
- Never install this barbecue inside any building, garage, shed or breezeway or inside a boat, caravan or recreational vehicle. This is to prevent the possibility of fire, carbon monoxide poisoning or asphyxiation.
- Any enclosure in which this appliance is installed shall comply with one of the following:
 - An enclosure with walls on all sides, but at least one permanent opening at the ground level and no overhead covering.
 - Within a partial enclosure that includes an overhead cover and no more than 2 walls.
 - Within a partial enclosure that includes an overhead cover and more than 2 walls, the following shall apply:
 - at least 25% of the total wall area is completely open and at least 30% of the remaining wall area is open and unrestricted.
- In the case of balconies, at least 20% of the total of the side, back and front wall areas shall be and remain open and unrestricted.

Outdoor area example 1

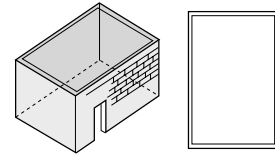

Outdoor area example 2

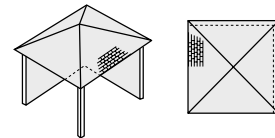

Outdoor area example 3

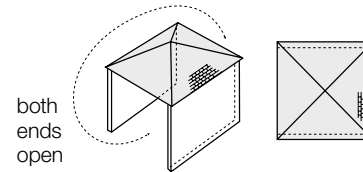

Outdoor area example 4

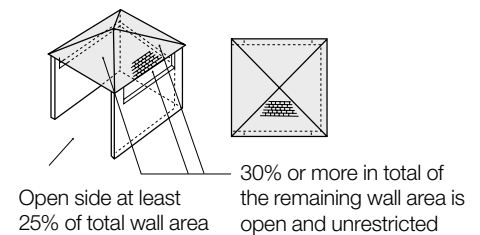

Outdoor area example 5

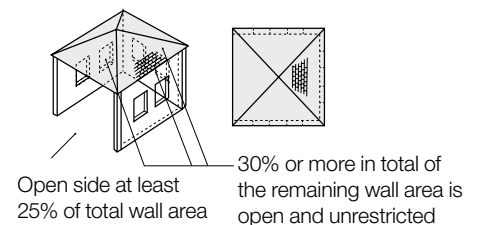

INSTALLATION INSTRUCTIONS

Choosing a location

- This appliance must not be installed on any combustible material.
- The vertical clearance above the cooking surface to any combustible materials must be at least 600mm.
- This appliance must be installed accordance with Australian Standards AS 4557 and AS 5601 and in accordance with local authority.
- When using LPG in an enclosure, ventilation must be provided. Gas is highly explosive and can cause serious injury and damage to property if allowed to accumulate and then be ignited.
- This appliance is intended to be built into a bench top with a minimum depth of 600mm.
- Avoid windy positions as this will affect cooking performance and burner efficiency. If this situation cannot be avoided some shielding may be necessary.
- If the chosen location is exposed to rain consideration will need to be given for water drainage. Some of the rain can drain through the benchtop hole and through the product.

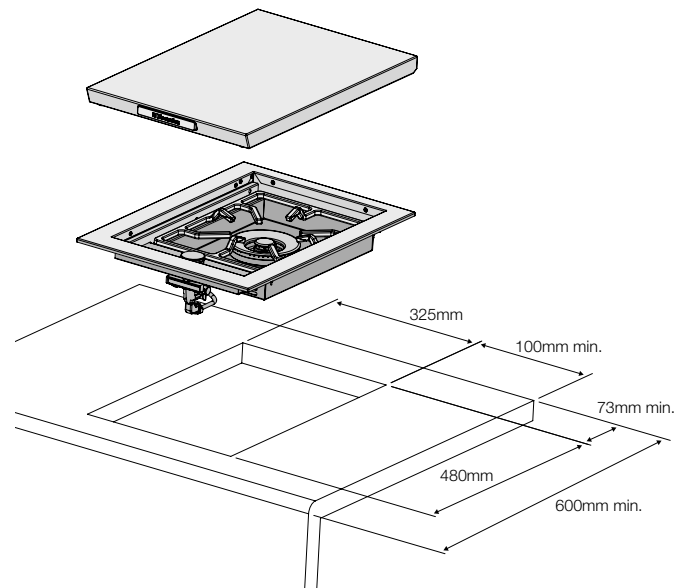
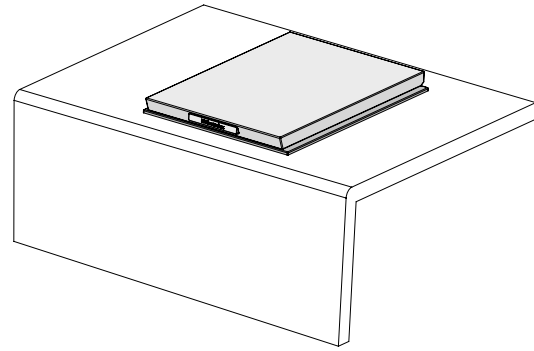

The mounting enclosure

- The burner requires a non-combustible barrier under the burner module to prevent excessive temperatures being accessed. The barrier panel is to be placed 30mm under the base of unit.
- For ULPG use, cabinetry below the barbecue must have low level ventilation to prevent the possibility of ULPG accumulating.
- The mounting enclosure must be constructed from non-combustible materials. Suitable materials for construction include masonry, granite, marble, Hardiplank®, Villaboard® over a metal frame or tiles. Any combustible materials within 200mm of the barbecue must be protected in accordance with clause 6.10.1.2 of AS/NZS 5601.1.

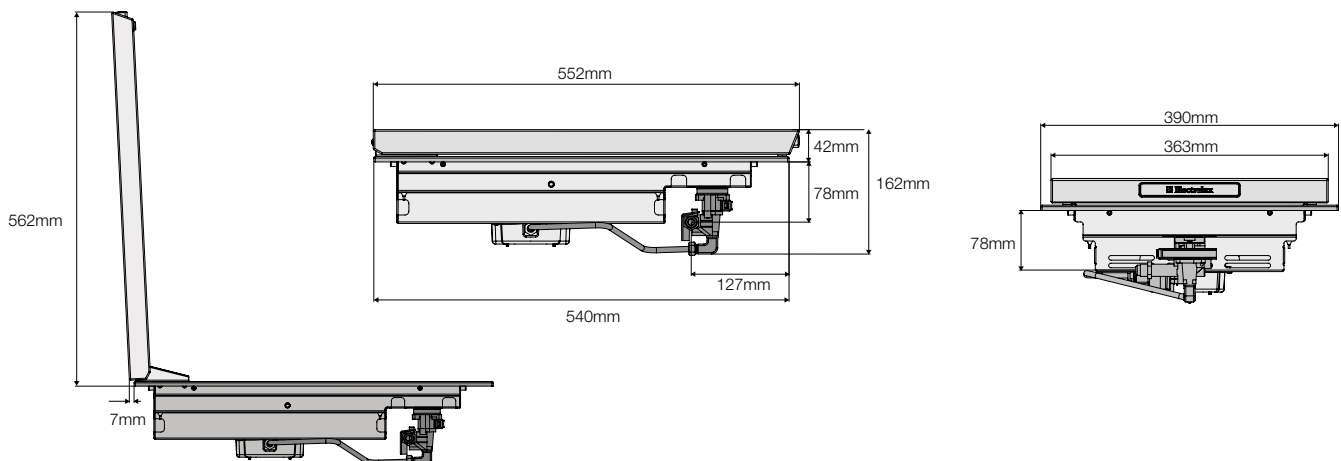

GAS REQUIREMENTS

Natural Gas requirements

- The enclosure must be constructed so that access can be gained to the Natural Gas regulator at all times.
- For Natural Gas the gas supply is required to be connected to 1.2m flexible hose supplied and therefore must be located within this distance.
- The flexible hose has a quick connect gas coupling. The corresponding mating fitting will be required at the gas supply end.
- For pipe sizing requirements for supply pipe refer to AS5601.

Universal LPG Requirements

- If an LPG bottle is to be stored in the enclosure under the burner unit, it must be isolated from the burner unit with a non-combustible panel. The enclosure must comply with the requirements of AS5601.
- AS5601 ventilation requirements for cylinder storage are:
 - Where of sheet metal or similar impervious construction there shall be ventilation openings at the top and bottom of the enclosure or recess, each opening providing a free area of at least 200cm² for every cylinder enclosed.
- For ULPG installations having enclosed cabinetry below the separation panel that does not contain a gas bottle, low level venting must be installed. This is to allow the gas which is heavier than air escape from the enclosure in the situation where there may be a leak. A minimum opening of 200cm² is required.

LOCATING INTEGRATED BURNER ADJACENT TO INTEGRATED BARBECUE

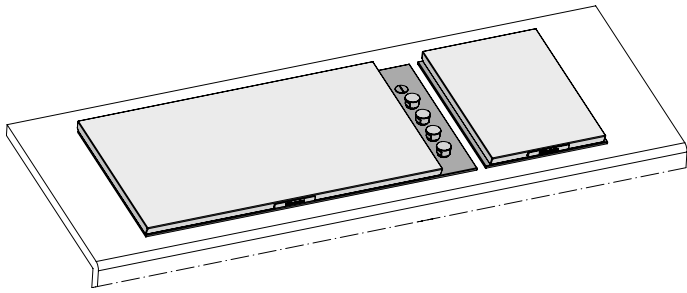

- If the integrated burner is to be located along side a built in barbecue, a minimum distance between them must be observed. This prevents heat transfer between the units.
- Refer to manufacturers instructions for construction requirements of specific bench top materials.

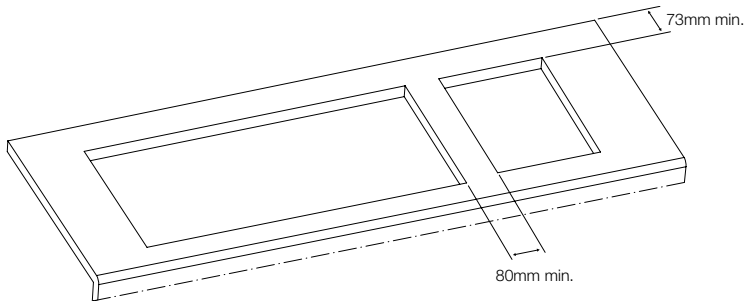

CONNECTING WITH ELECTROLUX INTEGRATED BARBECUE

If the integrated burner is located adjacent to the built in barbecue and the units are to be connected to the same outlet or cylinder, the gas line must branch off prior to the regulator. Each appliance must have its own regulator.

For Natural Gas

This can be achieved with hard plumbing to each of the regulators or by branching off after the flexible hose to each regulator.

From the regulator to the appliance the connection method remains unchanged.

For Universal LPG

This is achieved by adding fittings to branch off at the cylinder connection on the high pressure side. To each branch the regulator and hose assembly is fitted for each appliance. From the regulator and hose assembly to the appliance the connection method remains unchanged.

This appliance must be installed by a qualified licensed person. For piping size requirements for supply pipe refer to AS5601.

SETTING UP THE BURNER

Setting up the burner module in mounting enclosure

- After the enclosure has been constructed as described, position the assembled burner module into the cut-out hole.
- Check that the burner module is level and is firmly supported.
- Secure to enclosure with screws as shown. Do not over-tighten when securing unit to fixture as it may damage or distort inside walls.
- Connect to gas supply (Universal LPG or Natural Gas) and leak test.

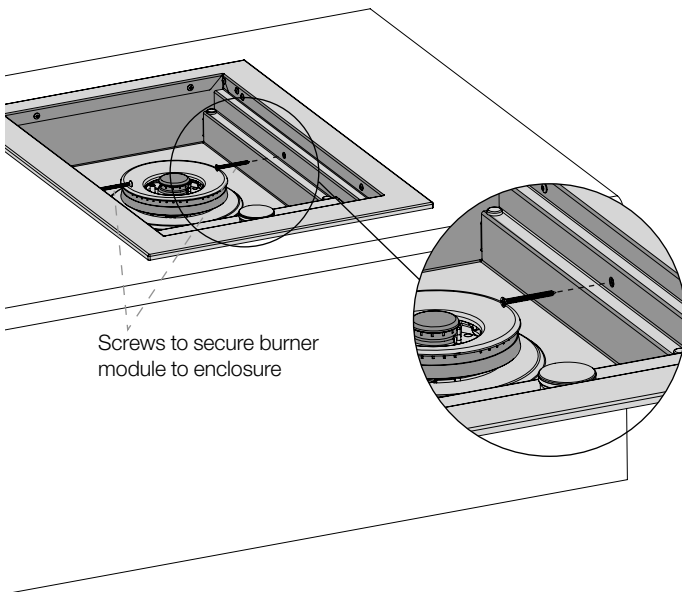

BURNER OPERATION

Control functions

Before lighting the burner:

- Check that all hoses and gas fittings are tight.
- Remove or pivot lid to open.

NOTE The lid is designed as a cover for weather protection. The lid is not designed to be used as a cooking hood.

- Check control knob is in the 'OFF' position.
- Ensure that the cooking surfaces are clean.
- Ensure that the gas isolation valve or the LPG bottle are 'ON'.

Lighting instructions

- Do not attempt to light burner with the cooking surfaces covered.
- To light a burner, depress the knob and rotate to 'RAPID PREHEAT'.
- If burner did not light, turn knob to the 'OFF' position. Allow gas to disperse, then repeat lighting procedure.

Manual lighting

- If, in the event of the automatic ignition system not working, the burner can be lit manually.
- Rotate the knob to the 'HIGH POSITION' and place a lighted match near to the burner.
- If the unit does not operate correctly refer to the troubleshooting section on page 17.

To turn the burner off

- When cooking is complete, rotate the knob fully clockwise so the pointer on the knob is positioned at the off position.

i IMPORTANT!

The burner trivet is designed for use with flat bottom pan or for a wok. This is achieved by simply turning the trivet over to suit the type of cooking desired. When using flat bottom pan ensure pan base diameter is at least 150mm to ensure pan stability on trivet

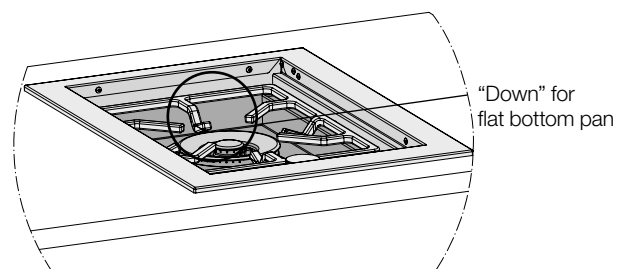
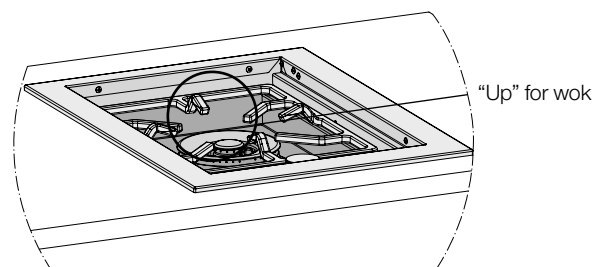

PIVOTING LID SAFETY LEG

To ensure that the user remembers to turn off the gas before closing the lid, a pivoting safety leg has been fitted.

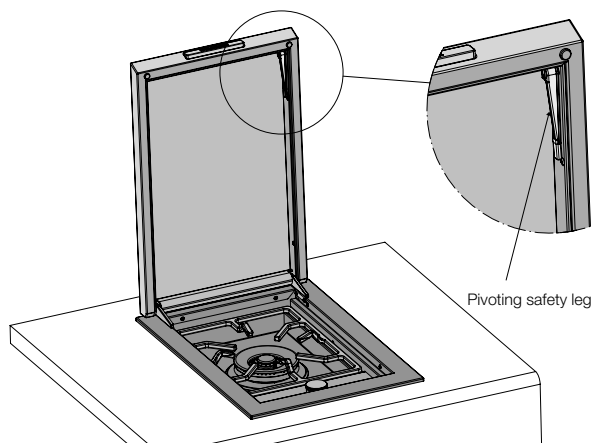

When closing the lid the safety leg will pivot forward and rest against the trim surface to prevent the lid closing. After ensuring the gas has been turned off, to fully close the lid, the leg needs to be rotated backwards.

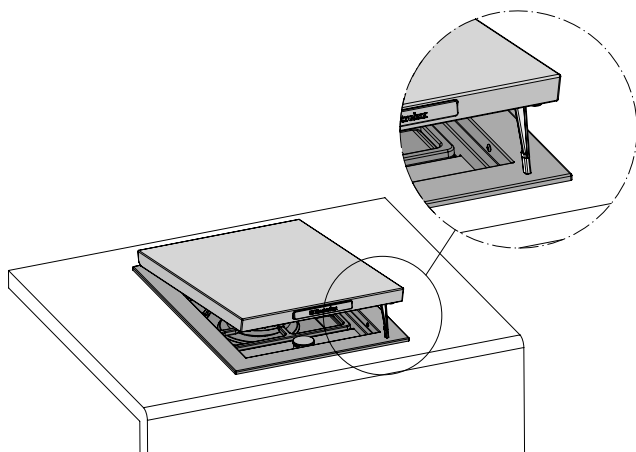

WARNING!

THE SLIMLINE LID MUST NOT BE CLOSED WHEN THE BURNER IS OPERATING.

Closing the lid during burner operation can cause discolouration and damage to the lid and burner unit.

CLEANING AND CARE

The Electrolux integrated burner has been constructed from select grade stainless steel which, if not cared for, may discolour over time. To keep your appliance looking its best we recommend that the cooking surfaces are cleaned after every use.

Cleaning

- Always ensure the appliance is turned off before cleaning.
- This appliance contains aluminium fittings. Do not use caustic based cleaners
- Do not use steam cleaners as this may cause moisture build up on electrical components.
- Always clean the appliance immediately after any food spoilage.

CAUTION!

Do not place burners in a dishwasher.

WARNING!

Please ensure that your appliance is switched off and has cooled down before following the instructions below.

Cleaning of Stainless Steel surfaces

CAUTION!

Do not use abrasive or caustic cleaners, scourers or metal scrapers on the stainless steel surfaces as they may permanently scratch and damage your appliance.

- Wash all stainless steel components, including the slimline lid and control knob cap with a soft dishcloth using hot soapy water.
- The interior can be wiped down with a soft cloth in hot soapy water.
- Ensure that all surfaces are dried with a clean dry cloth.

CAUTION!

Take extra care (particularly when cleaning on and around the control knob) to ensure that water and soapy residue do not enter the control panel, where the valve is located or into the burner. Care should also be taken not to disturb the spark electrode.

Trivet

The trivet can be removed for cleaning. Clean by washing in warm soapy water. Take care when replacing the trivets as dropping them may damage the enamelled surfaces.

Burner

The burner parts should be checked for blockages and cleared as required. If caps, crown and cup are heavily soiled, use a non-abrasive cleaning compound.

MAINTENANCE

IMPORTANT!

Special note on “tea staining”

Sometimes stainless steel surfaces are affected by a brown discolouration called tea staining. This usually occurs in areas which use high heat and can be easily removed using specialised stainless steel cleaners. For best results, we recommend that specialised cleaners be used regularly on all stainless steel components. You will find these cleaners at Electrolux spare parts outlets.

Burners

Burners should be checked at least once per year and cleaned as necessary. Inspect burners to ensure no residues have been deposited and gas ports are clear.

NOTE: that environmental conditions need to be taken into account with regards to the maintenance required on your product. In particular units installed in humid climates or seaside locations will be more susceptible to surface corrosion/discolouration over time. In these conditions Electrolux strongly recommends cleaning and drying your barbecue after every use and covering it when not in use to minimise exposure to the elements.

TROUBLESHOOTING

Problem	Possible cause	Remedy
Barbecue won't light	No gas	Check isolation valve is ON Gas bottle empty - refill or change gas bottle
	Ignition system not working	Ignition electrode wet or dirty Manually light the burner
Excess smoke being emitted from the cooking area	Gas valve set too high	Turn gas valves down or turn off selected burners
Smell of gas DO NOT ATTEMPT TO LIGHT THE APPLIANCE	Gas leak	Turn off gas at the isolation valves Check for leaks, tighten joints If problem persists call Electrolux Service
Not heating enough	Incorrect trivet orientation	Trivet wrong way round for cooking utensil being used (refer p14)

ACCESSORIES

To order any of the following accessories, or for more information on any other suitable accessories for this product, please contact the Electrolux Customer Service Centre.

Accessory	Item number
BBQ cleaner	ACC108
Weatherproof cover (for BBQ model EQBW40AS)	EQB40ACBL



FOR SALES IN AUSTRALIA AND NEW ZEALAND

APPLIANCE: ELECTROLUX INTEGRATED AND E:NV BARBECUE

This document sets out the terms and conditions of the product warranties for Electrolux Appliances. It is an important document. Please keep it with your proof of purchase documents in a safe place for future reference should you require service for your Appliance.

1. In this warranty:
 - (a) 'acceptable quality' as referred to in clause 10 of this warranty has the same meaning referred to in the ACL;
 - (b) 'ACL' means Schedule 2 to the Competition and Consumer Act 2010;
 - (c) 'Appliance' means any Electrolux product purchased by you and accompanied by this document;
 - (d) 'ASC' means Electrolux authorised service centres;
 - (e) 'Electrolux' means Electrolux Home Products Pty Ltd of 163 O'Riordan Street, Mascot NSW 2020, ABN 51 004 762 341 in respect of Appliances purchased in Australia and Electrolux (NZ) Limited (collectively 'Electrolux') of 3-5 Niall Burgess Road, Mount Wellington, in respect of Appliances purchased in New Zealand;
 - (f) 'major failure' as referred to in clause 10 of this warranty has the same meaning referred to in the ACL and includes a situation when an Appliance cannot be repaired or it is uneconomic for Electrolux, at its discretion, to repair an Appliance during the Warranty Period;
 - (g) 'Warranty Period' means the Appliance is warranted against manufacturing defects in Australia for 60 months and in New Zealand for 24 months, following the date of original purchase of the Appliance;
 - (h) 'you' means the purchaser of the Appliance not having purchased the Appliance for re-sale, and 'your' has a corresponding meaning.
2. This warranty only applies to Appliances purchased and used in Australia or New Zealand and used in normal domestic applications and is in addition to (and does not exclude, restrict, or modify in any way) any non-excludable statutory warranties in Australia or New Zealand.
3. During the Warranty Period Electrolux or its ASC will, at no extra charge if your Appliance is readily accessible for service, without special equipment and subject to these terms and conditions, repair or replace any parts which it considers to be defective. Electrolux or its ASC may use remanufactured parts to repair your Appliance. You agree that any replaced Appliances or parts become the property of Electrolux. This warranty does not apply to light globes, batteries, filters or similar perishable parts.
4. Parts and Appliances not supplied by Electrolux are not covered by this warranty.
5. To the extent permitted by law, you will bear the cost of transportation, travel and delivery of the Appliance to and from Electrolux or its ASC. If you reside outside of the service area, you will bear the cost of:
 - (a) travel of an authorised representative;
 - (b) transportation and delivery of the Appliance to and from Electrolux or its ASC.

In all instances, unless the Appliance is transported by Electrolux or an Electrolux authorised representative, the Appliance is transported at the owner's cost and risk while in transit to and from Electrolux or its ASC.
6. Proof of purchase is required before you can make a claim under this warranty.
7. You may not make a claim under this warranty unless the defect claimed is due to faulty or defective parts or workmanship. Electrolux is not liable in the following situations (which are not exhaustive):
 - (a) the Appliance is damaged by:
 - (i) accident
 - (ii) misuse or abuse, including failure to properly maintain or service
 - (iii) normal wear and tear
 - (iv) power surges, electrical storm damage or incorrect power supply
 - (v) incomplete or improper installation
 - (vi) incorrect, improper or inappropriate operation
 - (vii) insect or vermin infestation
 - (viii) failure to comply with any additional instructions supplied with the Appliance;
 - (b) the Appliance is modified without authority from Electrolux in writing;
 - (c) the Appliance's serial number or warranty seal has been removed or defaced;
 - (d) the Appliance was serviced or repaired by anyone other than Electrolux, an authorised repairer or ASC.
8. This warranty, the contract to which it relates and the relationship between you and Electrolux are governed by the law applicable where the Appliance was purchased. Where the Appliance was purchased in New Zealand for commercial purposes the Consumer Guarantee Act does not apply.
9. To the extent permitted by law and subject to your non-excludable statutory rights and warranties, Electrolux excludes all warranties and liabilities (other than as contained in this document) including liability for any loss or damage whether direct or indirect arising from your purchase, use or non use of the Appliance.
10. For Appliances and services provided by Electrolux in Australia, the Appliances come with a guarantee by Electrolux that cannot be excluded under the ACL. You are entitled to a replacement or refund for a major failure and for compensation for any other reasonably foreseeable loss or damage. You are also entitled to have the Appliance repaired or replaced if the Appliance fails to be of acceptable quality and the failure does not amount to a major failure. The benefits to you given by this warranty are in addition to your other rights and remedies under a law in relation to the Appliances or services to which this warranty relates.
11. At all times during the Warranty Period, Electrolux shall, at its discretion, determine whether repair, replacement or refund will apply if an Appliance has a valid warranty claim applicable to it.
12. For Appliances and services provided by Electrolux in New Zealand, the Appliances come with a guarantee by Electrolux pursuant to the provisions of the Consumer Guarantees Act, the Sale of Goods Act and the Fair Trading Act.
13. To enquire about claiming under this warranty, please follow these steps:
 - (a) carefully check the operating instructions, user manual and the terms of this warranty;
 - (b) have the model and serial number of the Appliance available;
 - (c) have the proof of purchase (e.g. an invoice) available;
 - (d) telephone the numbers shown below.
14. You accept that if you make a warranty claim, Electrolux and its ASC may exchange information in relation to you to enable Electrolux to meet its obligations under this warranty.

Important Notice

Before calling for service, please ensure that the steps listed in clause 13 above have been followed.

<p>FOR SERVICE or to find the address of your nearest state service centre in Australia PLEASE CALL 13 13 49 For the cost of a local call (Australia only)</p>	<p>SERVICE AUSTRALIA  Electrolux ELECTROLUX HOME PRODUCTS www.electrolux.com.au</p>	<p>FOR SPARE PARTS or to find the address of your nearest state spare parts centre in Australia PLEASE CALL 13 13 50 For the cost of a local call (Australia only)</p>
<p>FOR SERVICE or to find the address of your nearest authorised service centre in New Zealand FREE CALL 0800 10 66 10 (New Zealand only)</p>	<p>SERVICE NEW ZEALAND  Electrolux ELECTROLUX (NZ) Ltd www.electrolux.co.nz</p>	<p>FOR SPARE PARTS or to find the address of your nearest state spare parts centre in New Zealand FREE CALL 0800 10 66 20 (New Zealand only)</p>

Electrolux Home Products Australia

telephone: 1300 363 640
fax: 1800 350 067
email: customercare@electrolux.com.au
web: www.electrolux.com.au

Electrolux Home Products New Zealand

telephone: 0800 234 234
fax: 0800 363 600
email: customercare@electrolux.co.nz
web: www.electrolux.co.nz

The Thoughtful Design Innovator.

Do you remember the last time you opened a gift that made you say "Oh! How did you know? That's exactly what I wanted!" That's the kind of feeling that the designers at Electrolux seek to evoke in everyone who chooses or uses one of our products. We devote time, knowledge, and a great deal of thought to anticipating and creating the kind of appliances that our customers really need and want.

This kind of thoughtful care means innovating with insight. Not design for design's sake, but design for the user's sake. For us, thoughtful design means making appliances easier to use and tasks more enjoyable to perform, freeing our customers to experience that ultimate 21st century luxury, ease of mind. Our aim is to make this ease of mind more available to more people in more parts of their everyday lives, all over the world. So when we say we're thinking of you, you know we mean just that.

The "Thinking of you" promise from Electrolux goes beyond meeting the needs of today's consumers. It also means we're committed to making appliances safe for the environment—now and for future generations.

Electrolux. Thinking of you.

Share more of our thinking at www.electrolux.com.au or www.electrolux.co.nz

P/No. 0616-001-945 Rev B

© 2013 Electrolux Home Products Pty Ltd.
ABN 51 004 762 341

EMAN_INTBURNER_Nov13